

Idrostop PVC

PVC Waterstop for sealing structural joints



WHERE TO USE

For waterproofing structural joints in civil, industrial and hydraulic constructions.

Some application examples

Waterstops are used to make water-tight structural joints in underground reinforced concrete constructions to avoid ingress from the water table and in reinforced concrete structures used to contain water, such as swimming pools, water tanks and dams.

TECHNICAL CHARACTERISTICS

Idrostop PVC is a highly flexible waterstop made from high-quality thermo-plastic vinyl resins, forming a product with good resistance to mechanical stresses, aggressive chemical action in alkaline environment, sea-water and acids. **Idrostop PVC** is used within concrete structures exposed to temperatures from -30°C to $+70^{\circ}\text{C}$ and is highly resistant to damage caused by sunlight, ozone and other aggressive agents present in the atmosphere and water table.

The dimensions and type of **Idrostop PVC** used for each application generally depends on the following parameters:

- type of structure
- amount and type of movements predicted (e.g. no movement, axial movement, a combination of axial and transversal movements, etc.);
- thickness of the cast concrete

APPLICATION PROCEDURE

Idrostop PVC CJ & EJ ranges- embedded in the concrete

This type of joint is positioned at half thickness of the foundations or wall and must be stretched and held in position with wire. One end of the wire is attached to the reinforcement rods while the other end is attached to the waterstop. Insert a suitable type of compressible material between the first and second cast of concrete to form the joint (for EJ types) to prevent this from being clogged by any rigid material.

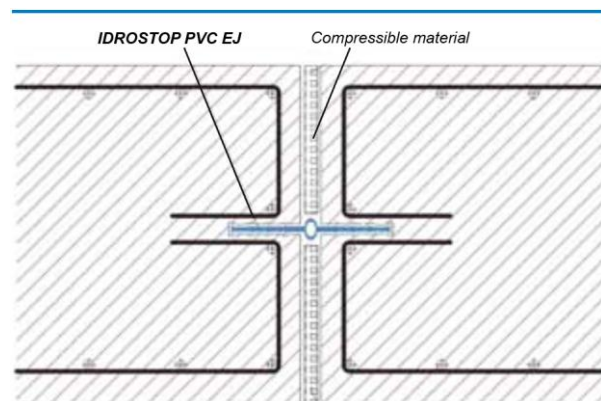

Layout of positioning Idrostop PVC EJ

Idrostop PVC RGC & RGE - external joint

This type of joint is fastened in place by nailing it directly to the formwork or the layer of lean concrete.

Idrostop PVC

The fixing lugs must face towards the next layer of cast concrete so that it forms a perfect bond. As with embedded joints, insert a suitable type of compressible material between the first and second cast of concrete to form the joint (for RGE types) to prevent this from being clogged by any rigid material.

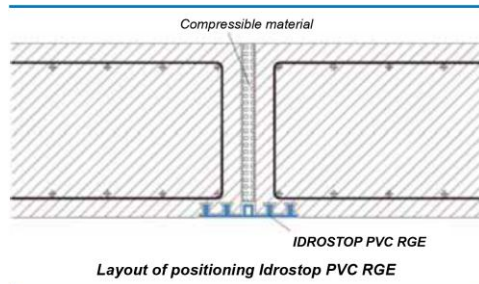

In the area immediately around the waterstop, vibrate the concrete so that it is perfectly compacted. When vibrating the concrete, care must be taken to avoid damaging or moving the **Idrostop PVC**.

Sizes available

Idrostop PVC CJ is available in three sizes:

CJ15 (width 15 cm);
CJ20 (width 20 cm);
CJ25 (width 25 cm).

Idrostop PVC EJ is available in three sizes:

EJ15 (width 15 cm);
EJ20 (width 20 cm);
EJ25 (width 25 cm).

Idrostop PVC RGC is available in two sizes:

RGC20 (width 20 cm);
RGC25 (width 25 cm).

Idrostop PVC RGE is available in two sizes:

RGE20 (width 20 cm);
RGE25 (width 25 cm).

PACKAGING

Idrostop PVC is supplied in 20metre rolls for 15cm and 20cm widths and 15metre rolls for 25cm widths, wrapped in polyethylene

PREFORMED INTERSECTION PIECES

Standard intersection pieces for L-, T- or X-junctions on flat or vertical placements are available for each Idrostop PVC waterstop profile.:

Idrostop PVC CJ15 – T Flat
Idrostop PVC CJ15 – L Flat
Idrostop PVC CJ15 – X Flat
Idrostop PVC CJ15 – T Vert
Idrostop PVC CJ15 – L Vert
Idrostop PVC CJ15 – X Vert

Idrostop PVC CJ20 – T Flat
Idrostop PVC CJ20 – L Flat
Idrostop PVC CJ20 – X Flat
Idrostop PVC CJ20 – T Vert
Idrostop PVC CJ20 – L Vert
Idrostop PVC CJ20 – X Vert

Idrostop PVC CJ25 – T Flat
Idrostop PVC CJ25 – L Flat
Idrostop PVC CJ25 – X Flat
Idrostop PVC CJ25 – T Vert
Idrostop PVC CJ25 – L Vert
Idrostop PVC CJ25 – X Vert

Idrostop PVC EJ15 – T Flat
Idrostop PVC EJ15 – L Flat
Idrostop PVC EJ15 – X Flat
Idrostop PVC EJ15 – T Vert
Idrostop PVC EJ15 – L Vert
Idrostop PVC EJ15 – X Vert

Idrostop PVC EJ20 – T Flat
Idrostop PVC EJ20 – L Flat
Idrostop PVC EJ20 – X Flat
Idrostop PVC EJ20 – T Vert
Idrostop PVC EJ20 – L Vert
Idrostop PVC EJ20 – X Vert

Idrostop PVC EJ25 – T Flat
Idrostop PVC EJ25 – L Flat
Idrostop PVC EJ25 – X Flat
Idrostop PVC EJ25 – T Vert
Idrostop PVC EJ25 – L Vert
Idrostop PVC EJ25 – X Vert

Idrostop PVC RGC20 – T Flat
Idrostop PVC RGC20 – L Flat
Idrostop PVC RGC20 – X Flat
Idrostop PVC RGC20 – T Vert
Idrostop PVC RGC20 – L Vert
Idrostop PVC RGC20 – X Vert

Idrostop PVC RGC25 – T Flat
Idrostop PVC RGC25 – L Flat
Idrostop PVC RGC25 – X Flat
Idrostop PVC RGC25 – T Vert
Idrostop PVC RGC25 – L Vert
Idrostop PVC RGC25 – X Vert

Idrostop PVC RGE20 – T Flat
Idrostop PVC RGE20 – L Flat
Idrostop PVC RGE20 – X Flat
Idrostop PVC RGE20 – T Vert
Idrostop PVC RGE20 – L Vert
Idrostop PVC RGE20 – X Vert

Idrostop PVC RGE25 – T Flat
Idrostop PVC RGE25 – L Flat
Idrostop PVC RGE25 – X Flat
Idrostop PVC RGE25 – T Vert
Idrostop PVC RGE25 – L Vert
Idrostop PVC RGE25 – X Vert



Sealing a structural joint on a vertical wall

SITE WELDING EQUIPMENT

Welding on site is done using a **Idrostop PVC Welding Iron** which features thermostat temperature control. Well-formed butt joints are achieved by securing the waterstop profiles in welding jigs to suit the different sizes :

Idrostop PVC Welding Jig CJ15
 Idrostop PVC Welding Jig EJ15
 Idrostop PVC Welding Jig CJ20
 Idrostop PVC Welding Jig EJ20
 Idrostop PVC Welding Jig RGC20
 Idrostop PVC Welding Jig RGE20
 Idrostop PVC Welding Jig CJ25
 Idrostop PVC Welding Jig EJ25
 Idrostop PVC Welding Jig RGC25
 Idrostop PVC Welding Jig RGE25



Sealing a structural joint on foundation

TECHNICAL DATA FOR IDROSTOP PVC WATERSTOP

(Valid for all profile types)

Typical physical-mechanical properties	Method	u.m.	Value
Hardness	ISO 868:2003	Shore A	80 ± 2
Specific Gravity	BS 2782-6 Method 620A:1991	g/cm ³	1.40 ± 0.05
Tensile strength	ISO 37:2005	MPa	14
Elongation at break	ISO 37:2005	%	325
Water Absorption, 32°C	ISO 62:2008	%	0.21
Thermal Stability	BS EN 60811-3-2:1995	minutes	106
Loss of Mass	BS EN 60811-3-2:1995	g/cm ³	0.004

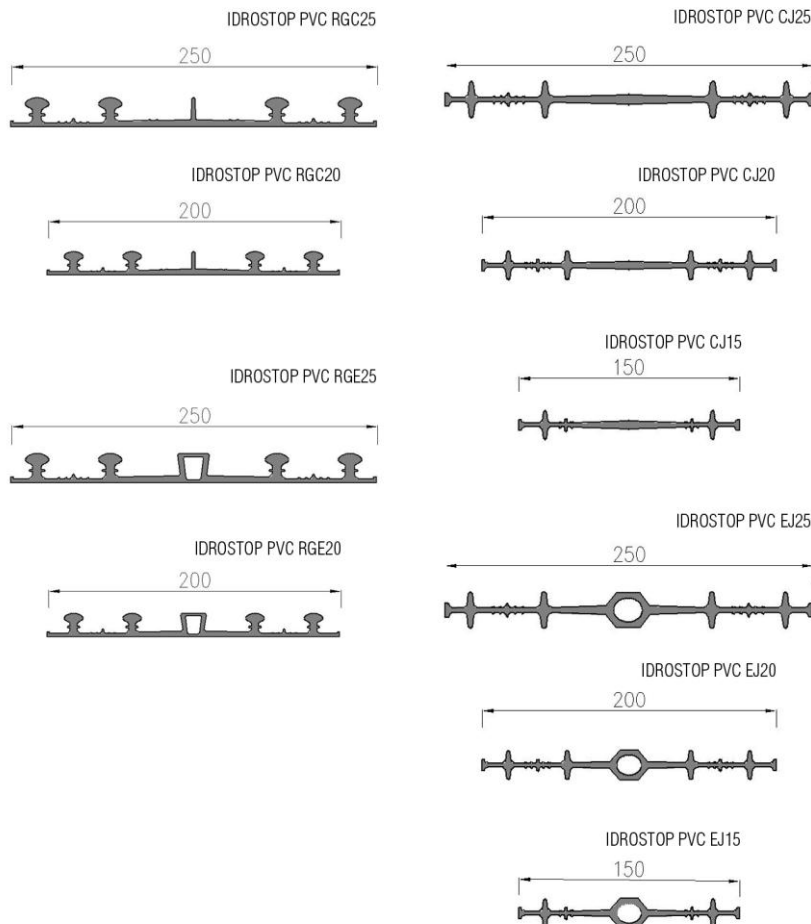

Idrostop PVC

STORAGE

Store in a dry place at a temperature of between +10°C and +40°C.

PRODUCT FOR PROFESSIONAL USE.

WARNING

While the indications and guidelines contained in this data sheet correspond to the company's knowledge and wide experience, they must be considered, under all circumstances, merely as an indication and subject to confirmation only after

long-term, practical applications. Therefore, anybody who undertakes to use this product, must ensure beforehand that it is suitable for the intended application and, in all cases, the user is to be held responsible for any consequences deriving from its use.

All relevant references for the product are available upon request.



BUILDING THE FUTURE

MAPEI Malaysia Sdn. Bhd. (231780-K)
PT 521, Batu 23, Jalan Rawang/Jalan Batang Berjuntai,
48000 Rawang, Selangor Darul Ehsan
Tel: +(6)03-6093 5799 – Fax: +(6)03-6091 5801
e-mail: mapei@mapei.com.my – website: www.mapei.com.my

2092-8-2012